



DISTINCTIVE CATERING VENUES

# international market square



a dramatic five-story glass atrium

SINCE 1995

Unique spaces for private dining



NOAH WOLF

ATRIUM



NOAH WOLF

ATRIUM



NOAH WOLF

ATRIUM

COMPLETE PHOTO LIBRARY AT [FLICKR.COM/DAMICOCATERING](https://www.flickr.com/photos/damicocatering/)



**LOCATION & CONTACT**

Phone: 612.238.4444  
 Fax: 612.238.4040  
 Website: [www.damicocatering.com](http://www.damicocatering.com)

D'Amico Catering at  
 International Market Square  
 275 Market Street  
 Minneapolis, MN 55405

CAPACITIES/SPACE*	THEATER	RECEPTION	BUFFET	PLATED	SQUARE FEET
ATRIUM	N/A	4000	1800	2200	60887
ATRIUM - 1ST FLOOR	500	1250	350	450	10570
STUDIO 185	300	375	210	210	4211

\*Capacities are only a guide and are approximate

International Market Square (IMS) is a spacious, glass-roofed building located on the edge of downtown Minneapolis. Built between 1905 and 1915 and listed on the National Register of Historic Places, IMS is Minnesota's largest renovated structure. With two distinctive spaces, it's perfect for any type of event. The stunning atrium has a peaked glass roof rising 72 feet above the sun-washed space and can be configured to accommodate groups of all sizes. A former factory that is now the chic setting for numerous interior design showrooms, offices and residential lofts, IMS is an aesthetic gem.

**AMENITIES**

- Stunning Entrance
- Baby Grand Piano
- Formal Stage and Dance Floor
- National Register of Historic Places
- House Sound System
- Professional Technical Services
- Audio-Visual Services
- Professional Event Managers
- Complimentary Votive Candles
- Central Location and Easy Accessibility
- Outside Downtown Tax Zone
- On-Site Full Kitchen
- Award Winning D'Amico Cuisine
- Ample Complimentary Parking and Optional Valet Services

**BOOKING GUIDELINES**

Tours: Given by D'Amico, call to schedule  
 Rental Fee: Varies, call for pricing  
 Availability: Daily, Day and Evening Events  
 Floor Plans: Custom designed by D'Amico  
 Bar: Cash and Hosted (Open Bar) allowed

**COMPLIMENTARY TABLES AND CHAIRS**

(Limited Quantities Available)

- 72" Rounds seat 10 people
- 30" x 30" and 30" x 40" Tables
- 30" High and Low Cocktail Tables
- Brown Stitch Leather Chairs (15.5"w x 34"h)
- 4' x 30", 6' x 30", and 8' x 30" Rectangular Tables
- Brown Leather Chairs (18"w x 32"h)
- Half Moon (5' x 30") and Serpentine (6' x 30") Tables
- Cloth Chairs (19"w x 32"h)
- Bar Stools

VENUE : INTERNATIONAL MARKET SQUARE

FLOOR PLAN

EVENT : ATRIUM THEATER STYLE SEATING

GUEST CAPACITY: 500

TABLES:



LOW COCKTAIL TABLE



HIGH COCKTAIL TABLE

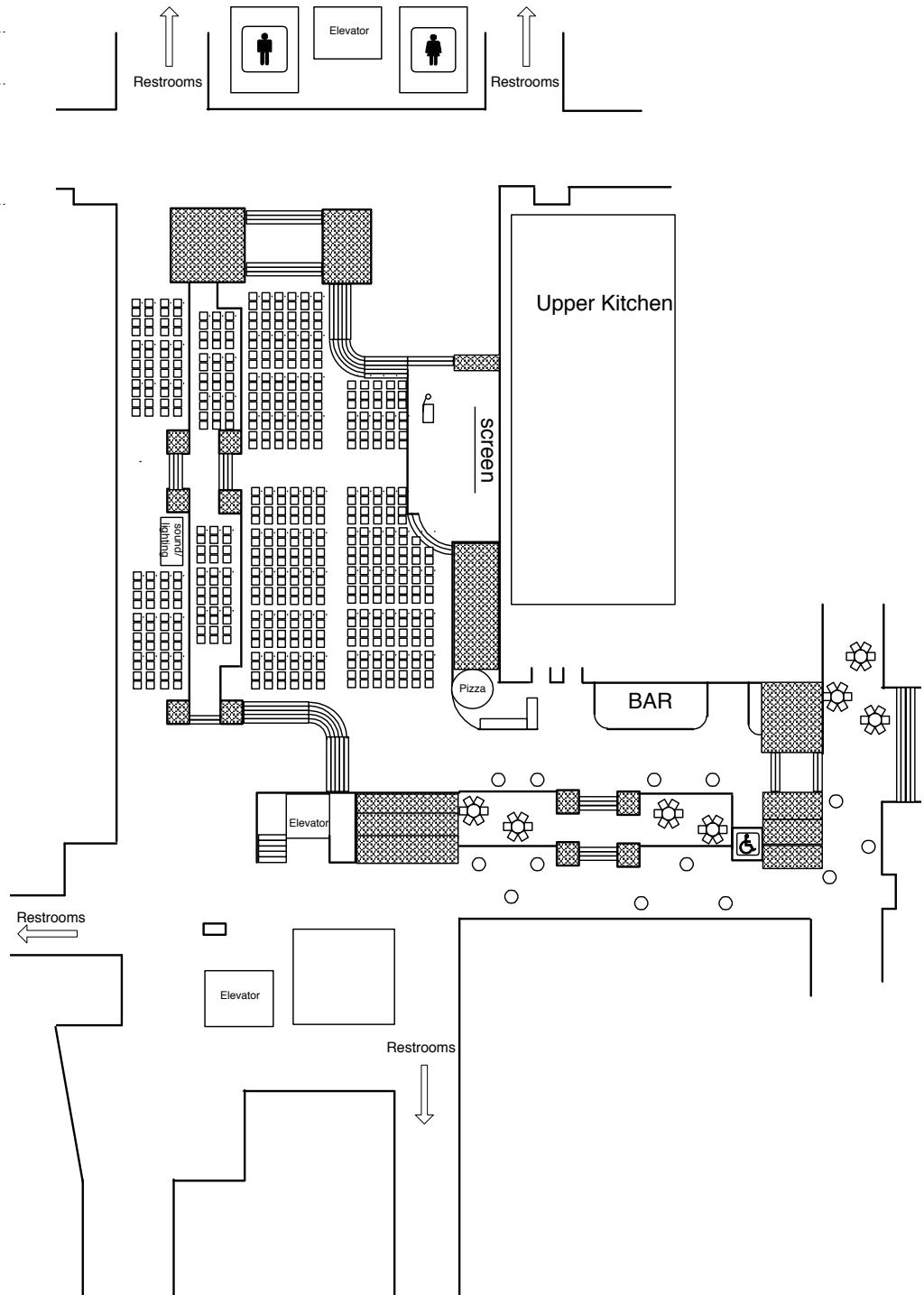

VENUE: INTERNATIONAL MARKET SQUARE

FLOOR PLAN

EVENT: ATRIUM BUFFET

GUEST CAPACITY: 336

**TABLES:**

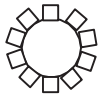

30 ROUNDS OF 10 SEATS



6 RECTANGLES OF 6 SEATS



HIGH COCKTAIL TABLE

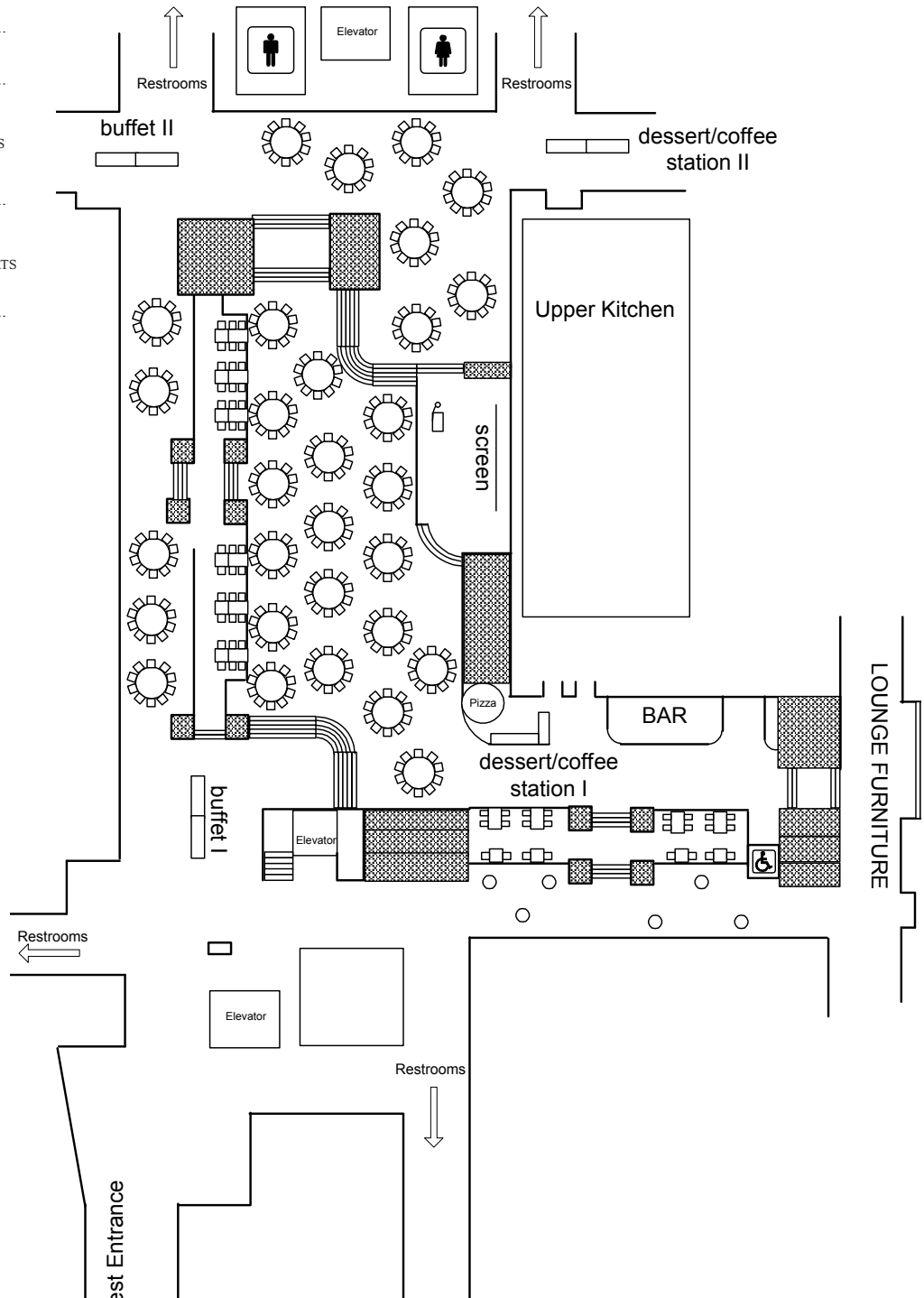

EVENT : ATRIUM FUNDRAISER

GUEST CAPACITY: 376

TABLES:

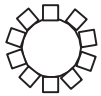

34 ROUNDS OF 10 SEATS



6 RECTANGLES OF 6 SEATS



29 AUCTION TABLES



HIGH COCKTAIL TABLE

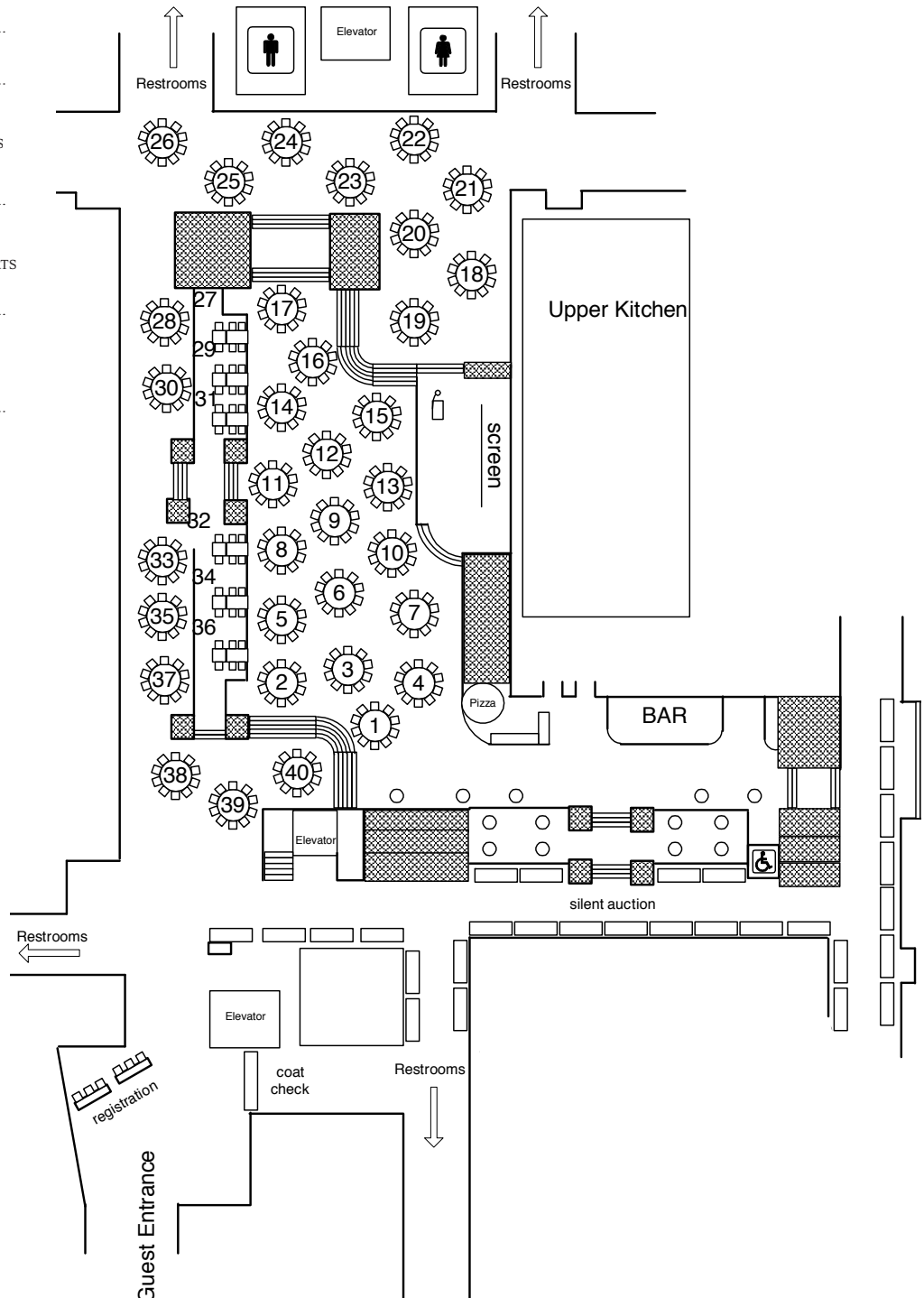

VENUE : INTERNATIONAL MARKET SQUARE

FLOOR PLAN

EVENT : ATRIUM WEDDING CEREMONY

GUEST CAPACITY: 300

TABLES:



HIGH COCKTAIL TABLES

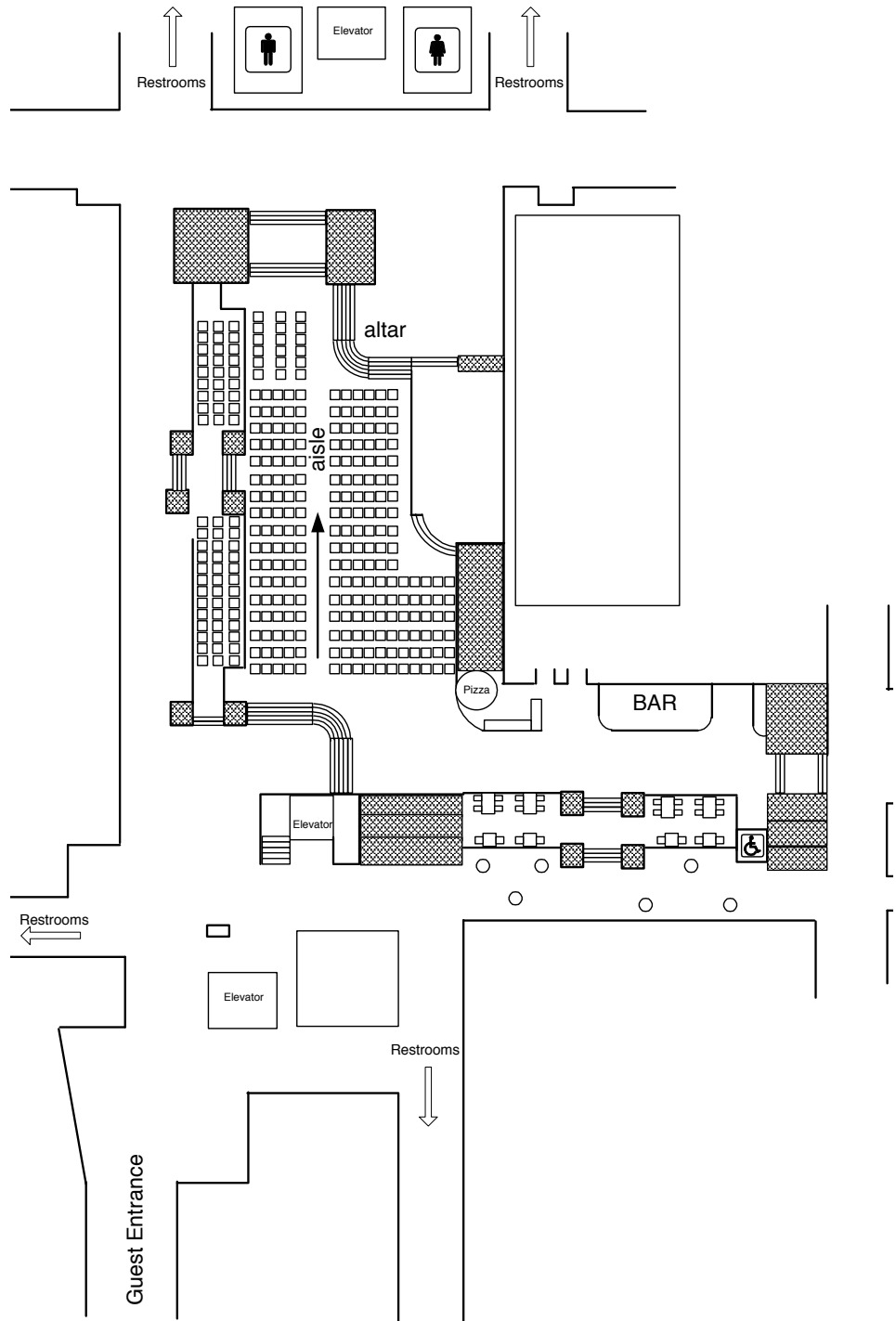

VENUE : INTERNATIONAL MARKET SQUARE

FLOOR PLAN

EVENT : ATRIUM WEDDING RECEPTION

GUEST CAPACITY: 358

**TABLES:**

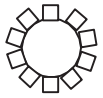

31 ROUNDS OF 10 SEATS



6 RECTANGLES OF 6 SEATS



HEAD TABLE OF 12 SEATS



HIGH COCKTAIL TABLES

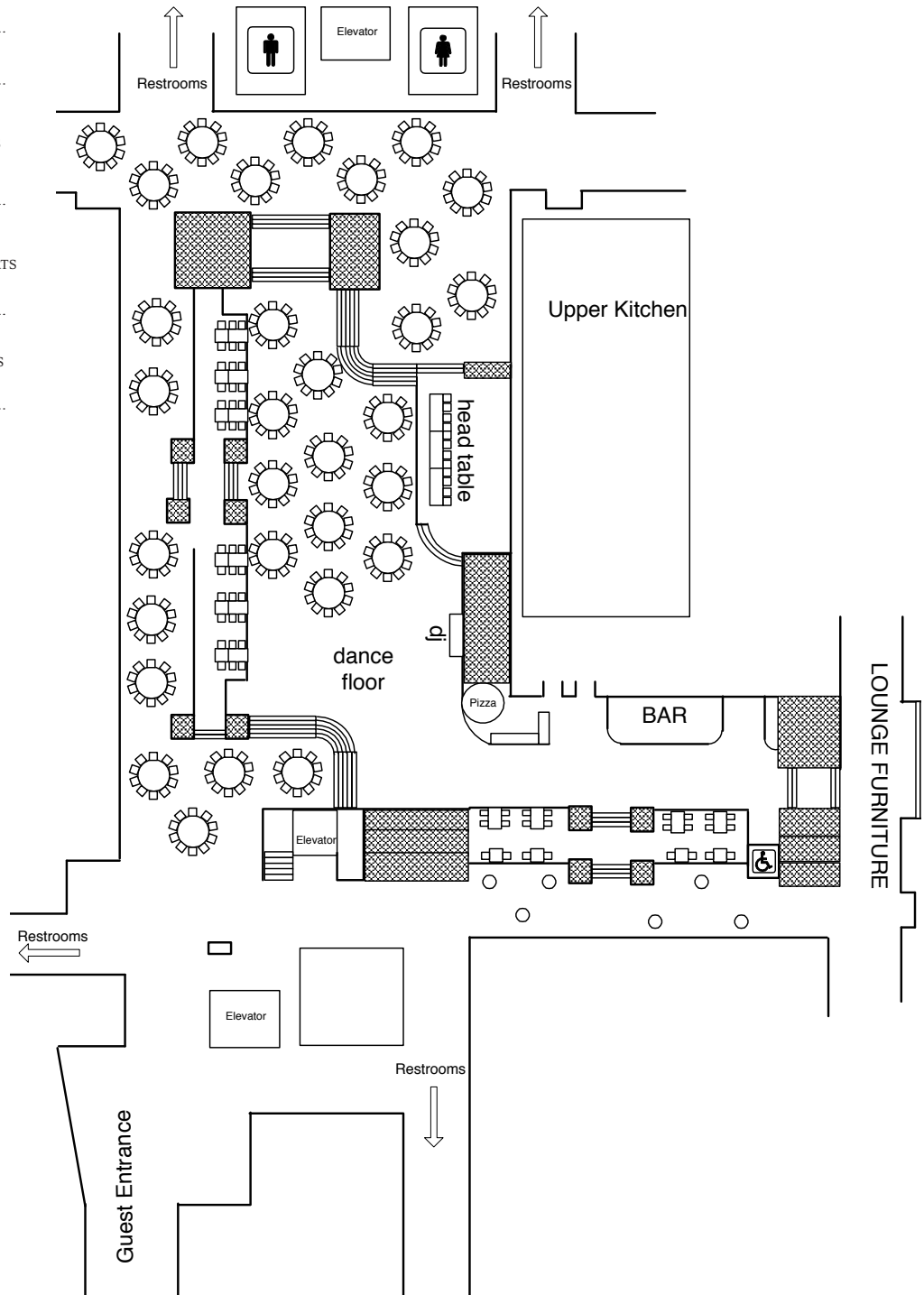

VENUE: INTERNATIONAL MARKET SQUARE

FLOOR PLAN

EVENT: ATRIUM 1<sup>ST</sup> FLOOR MAXIMUM CAPACITY GUEST CAPACITY: 456

**TABLES:**

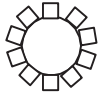

42 ROUNDS OF 10 SEATS



6 RECTANGLES OF 6 SEATS



HIGH COCKTAIL TABLES

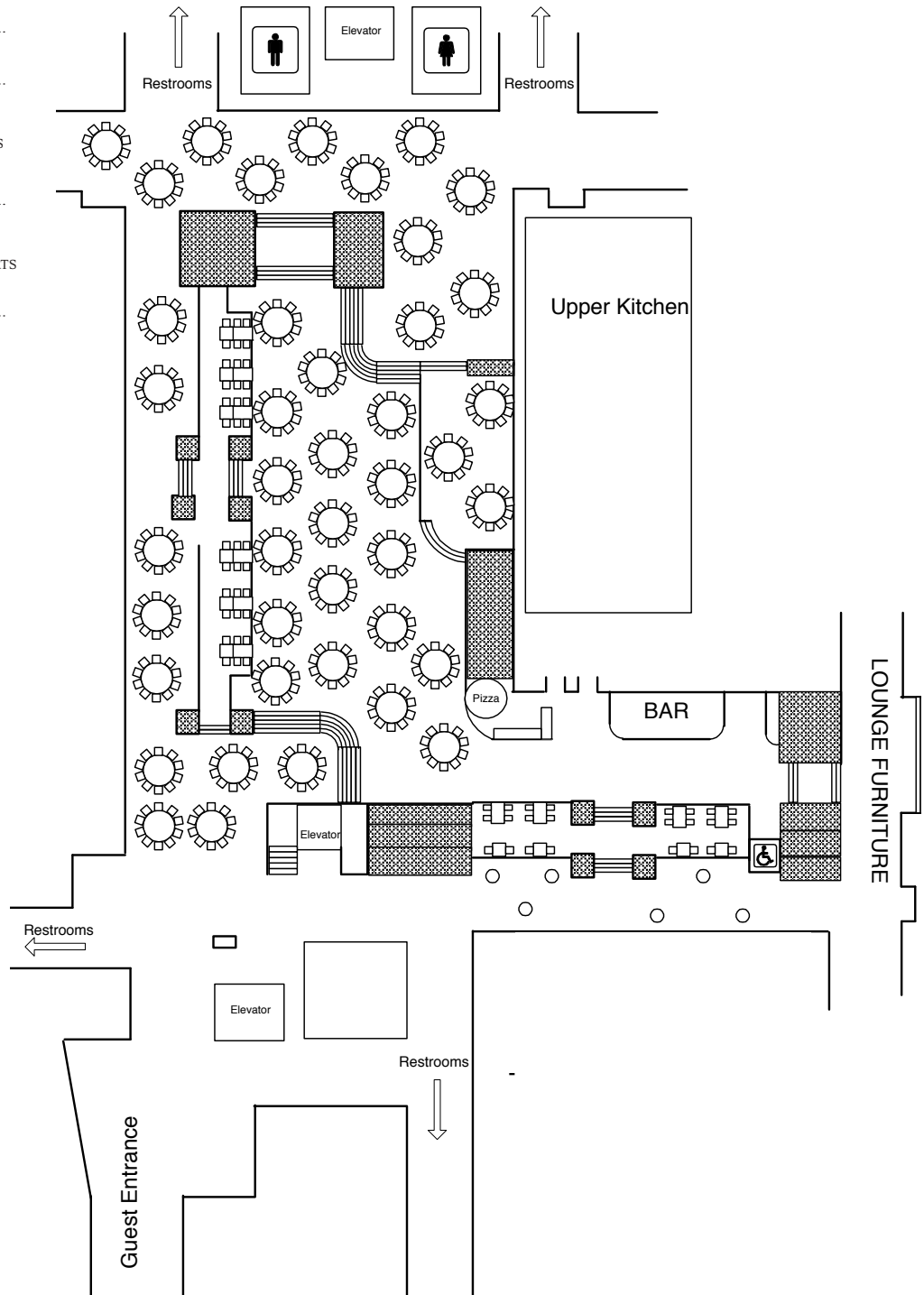



EVENT : ATRIUM MEASUREMENTS

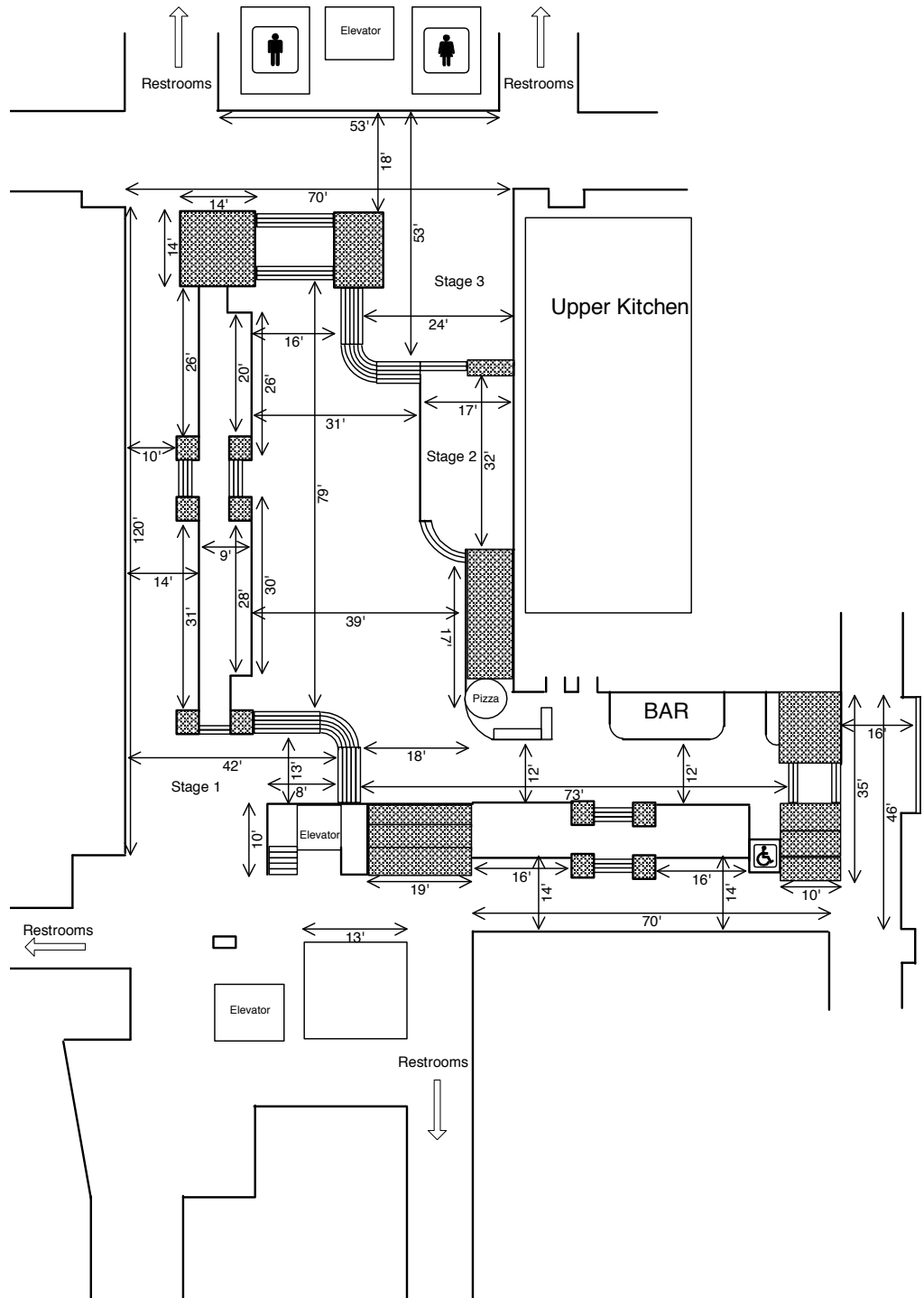

EVENT : ATRIUM OUTLETS

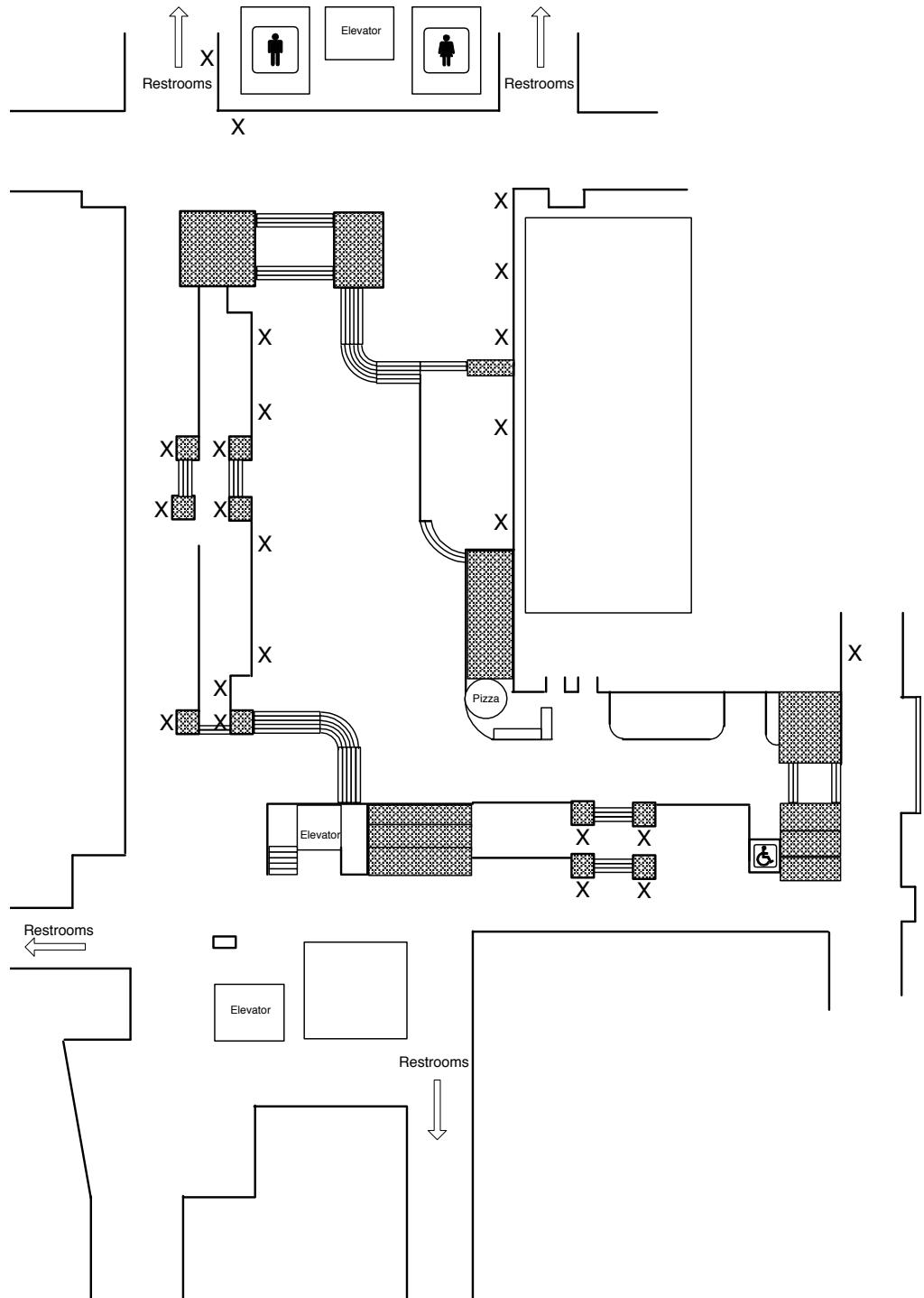

VENUE : INTERNATIONAL MARKET SQUARE

FLOOR PLAN

EVENT : SECOND FLOOR SEATING

GUEST CAPACITY: 188

TABLES:

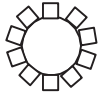

8 ROUNDS OF 10 SEATS



3 ROUNDS OF 6 SEATS



15 RECTANGLES OF 6 SEATS

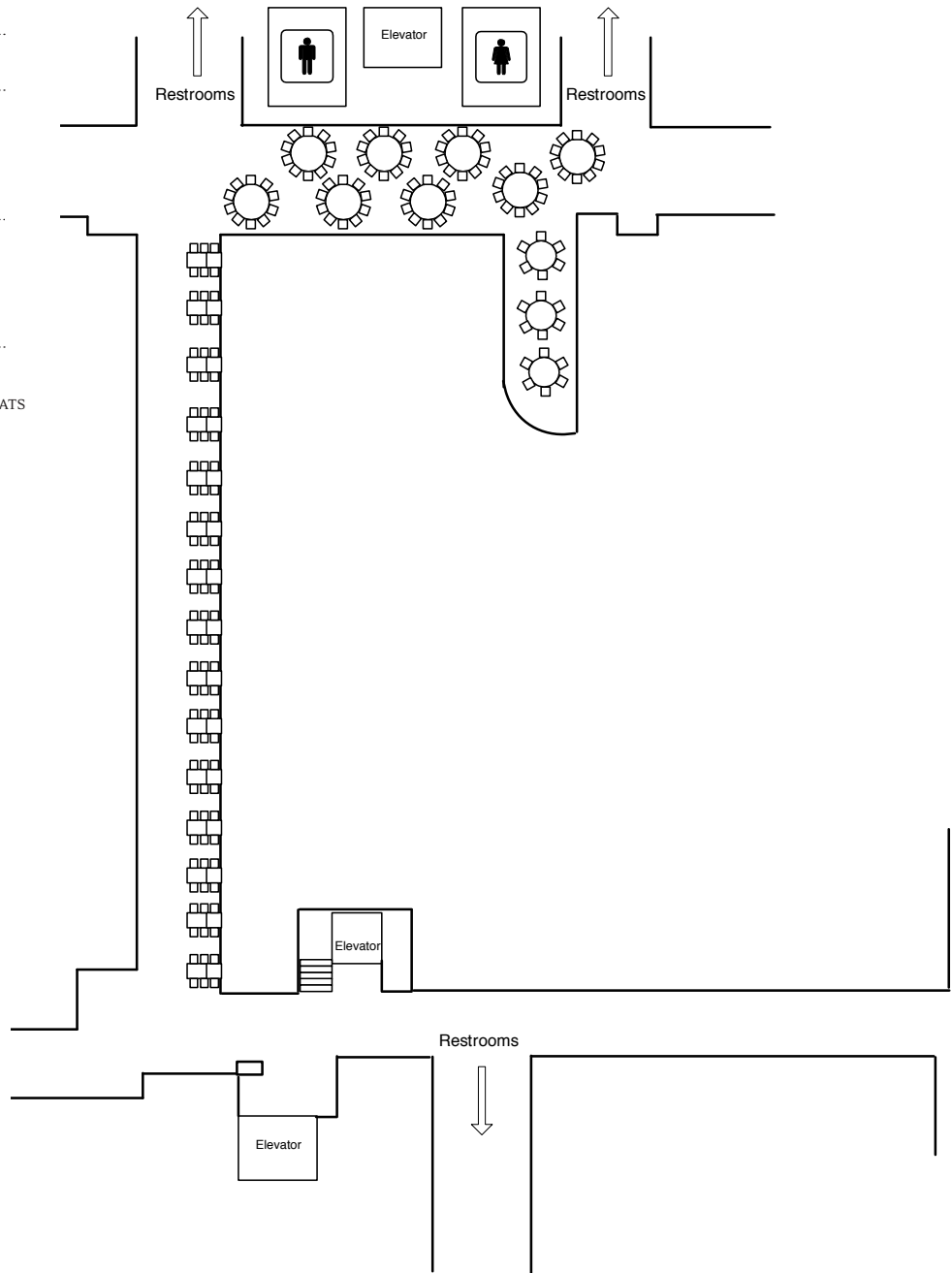

VENUE : INTERNATIONAL MARKET SQUARE

FLOOR PLAN

EVENT : THIRD FLOOR SEATING

GUEST CAPACITY: 170

TABLES:



8 ROUNDS OF 10 SEATS



15 RECTANGLES OF 6 SEATS

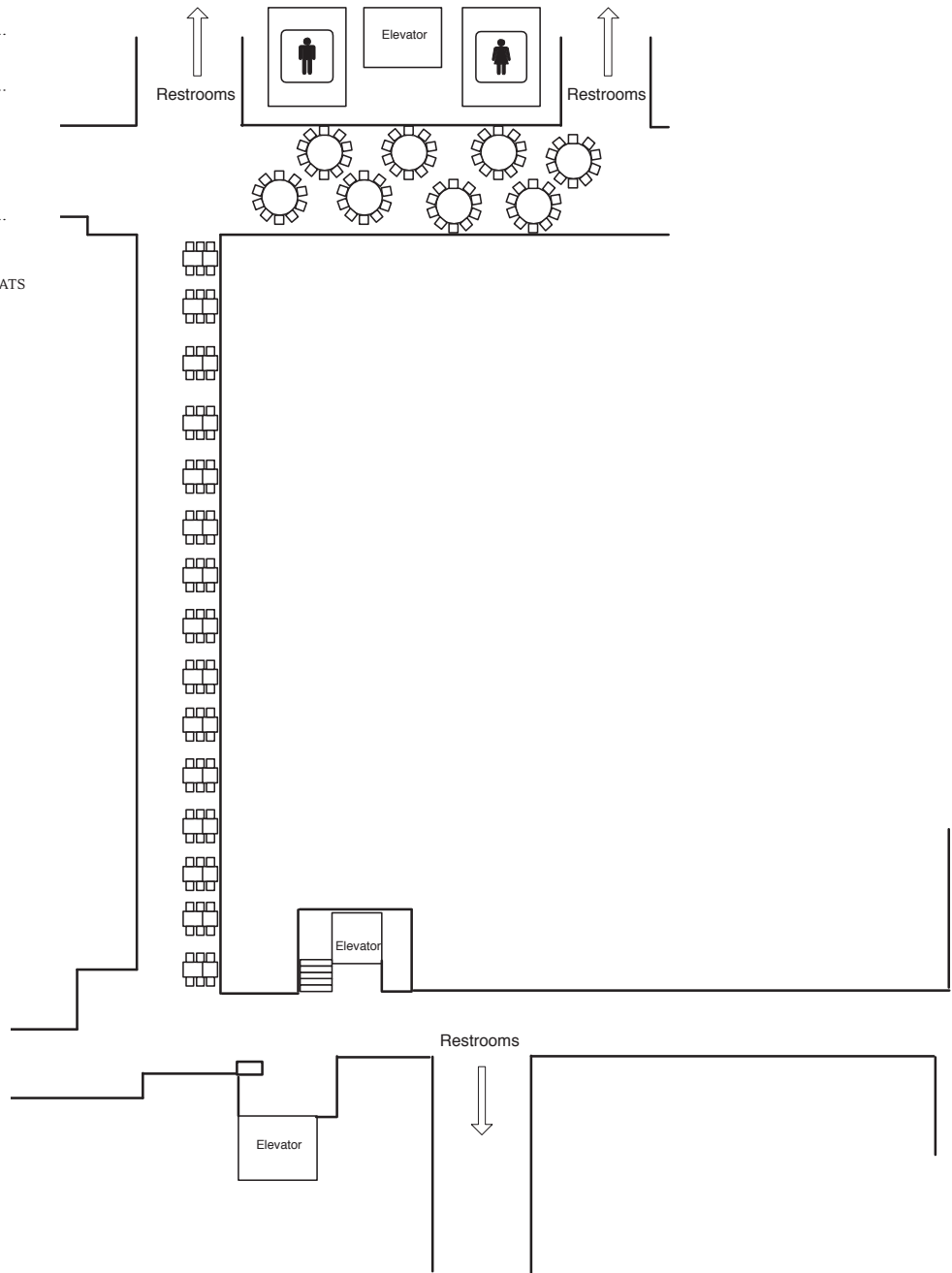

VENUE : INTERNATIONAL MARKET SQUARE

FLOOR PLAN

EVENT : FOURTH FLOOR SEATING

GUEST CAPACITY: 170

**TABLES:**

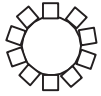

8 ROUNDS OF 10 SEATS



15 RECTANGLES OF 6 SEATS

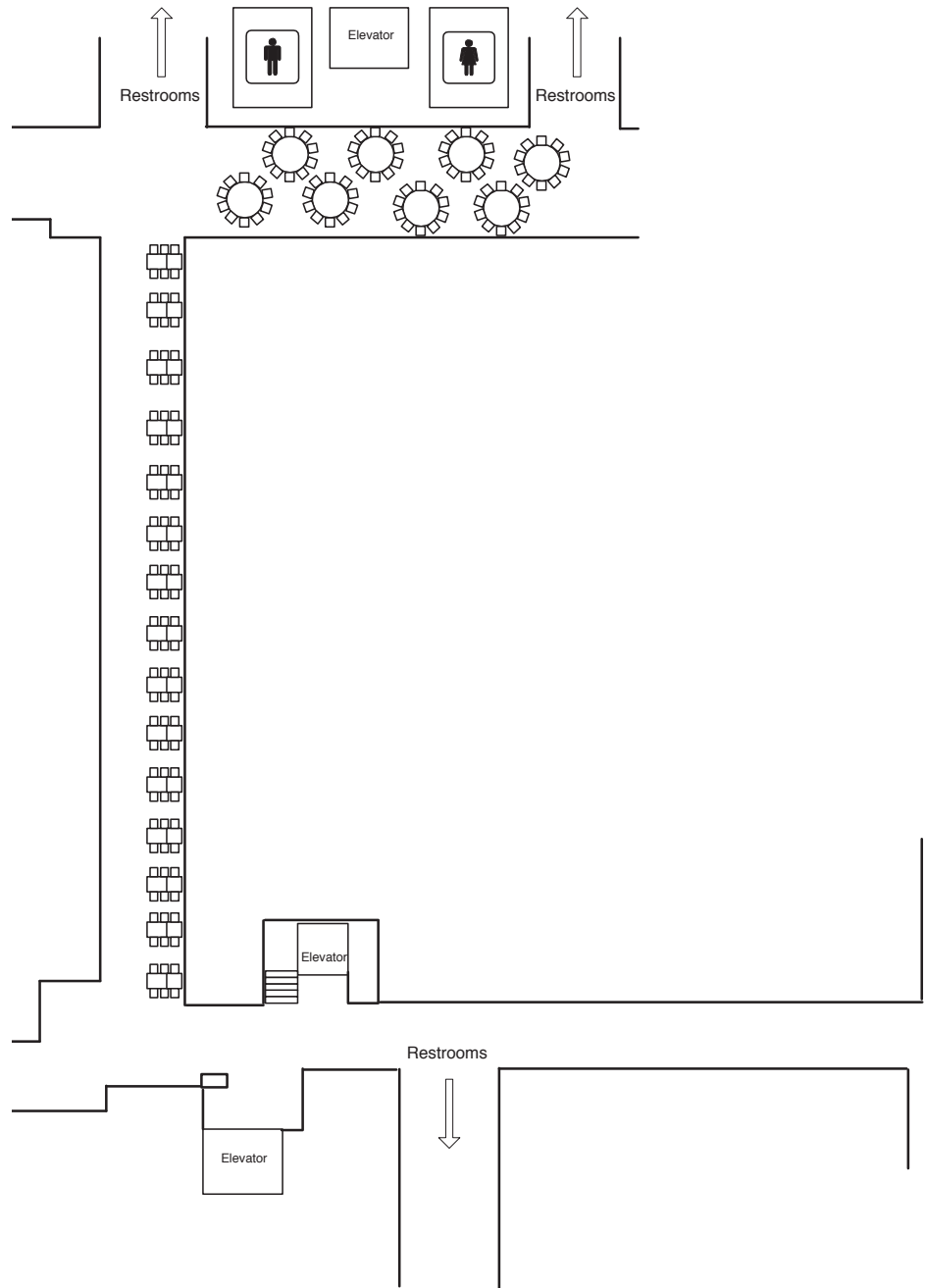

VENUE : INTERNATIONAL MARKET SQUARE

FLOOR PLAN

EVENT : FIFTH FLOOR SEATING

GUEST CAPACITY: 170

**TABLES:**

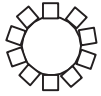

8 ROUNDS OF 10 SEATS



15 RECTANGLES OF 6 SEATS

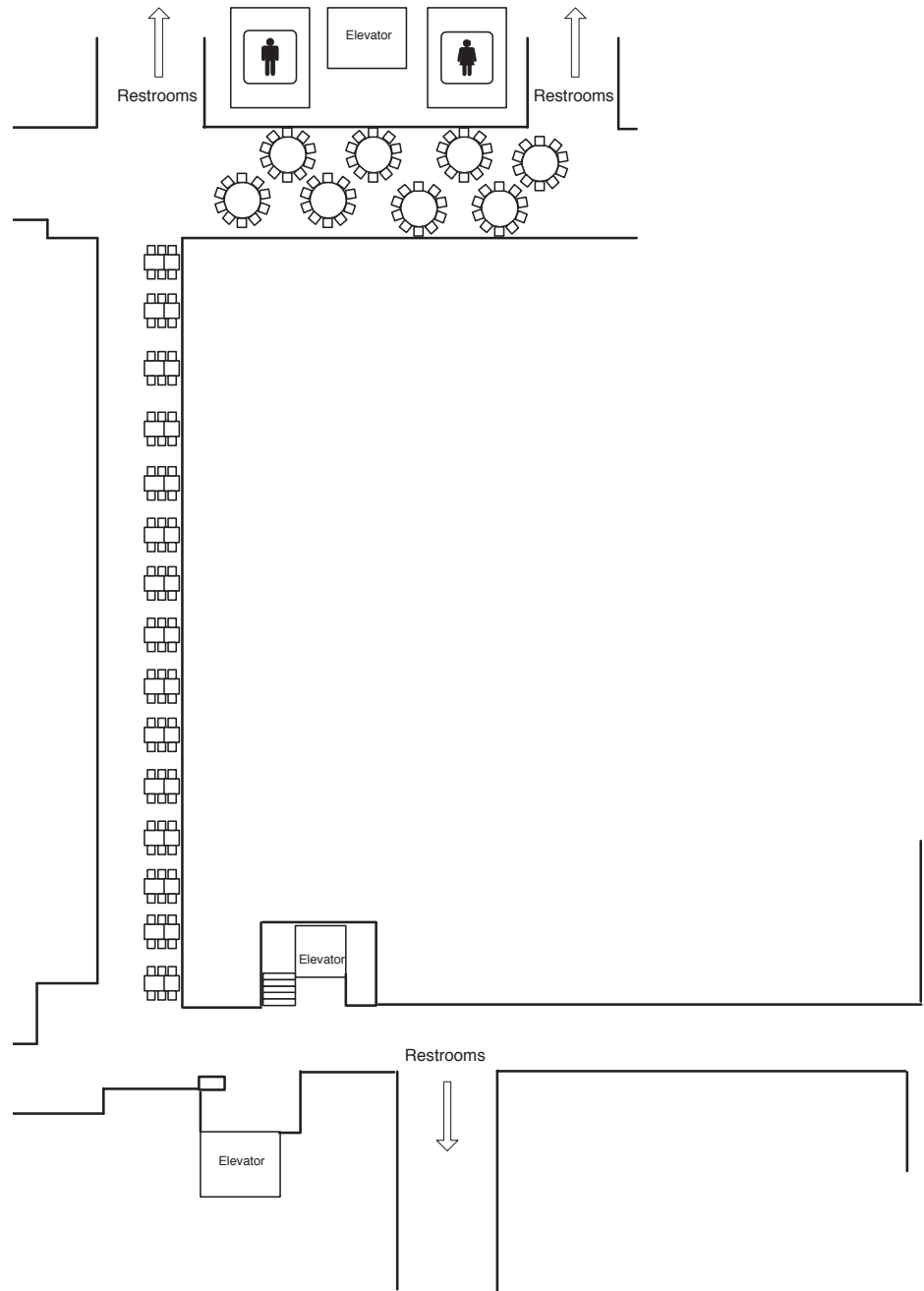

VENUE : INTERNATIONAL MARKET SQUARE

FLOOR PLAN

EVENT : STUDIO 185 THEATER STYLE SEATING

GUEST CAPACITY: 300

TABLES:

NONE

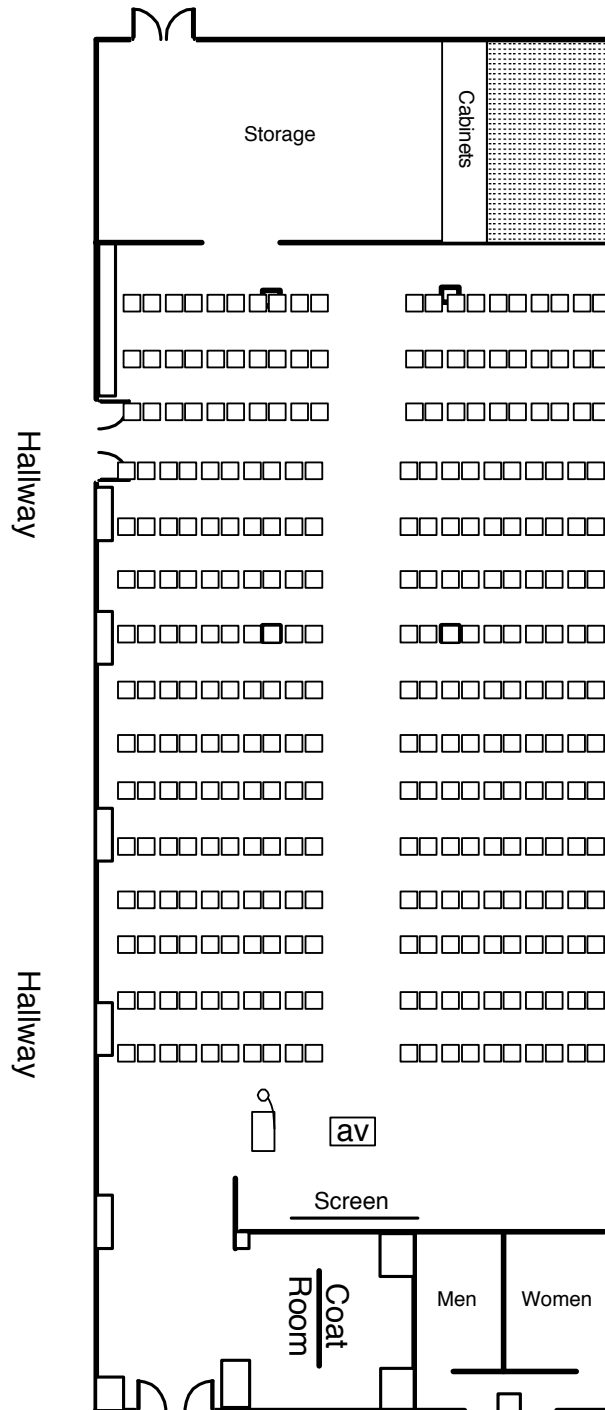

VENUE : INTERNATIONAL MARKET SQUARE

FLOOR PLAN

EVENT : STUDIO 185 BUFFET DINNER

GUEST CAPACITY: 210

**TABLES:**

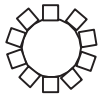

21 ROUNDS OF 10 SEATS

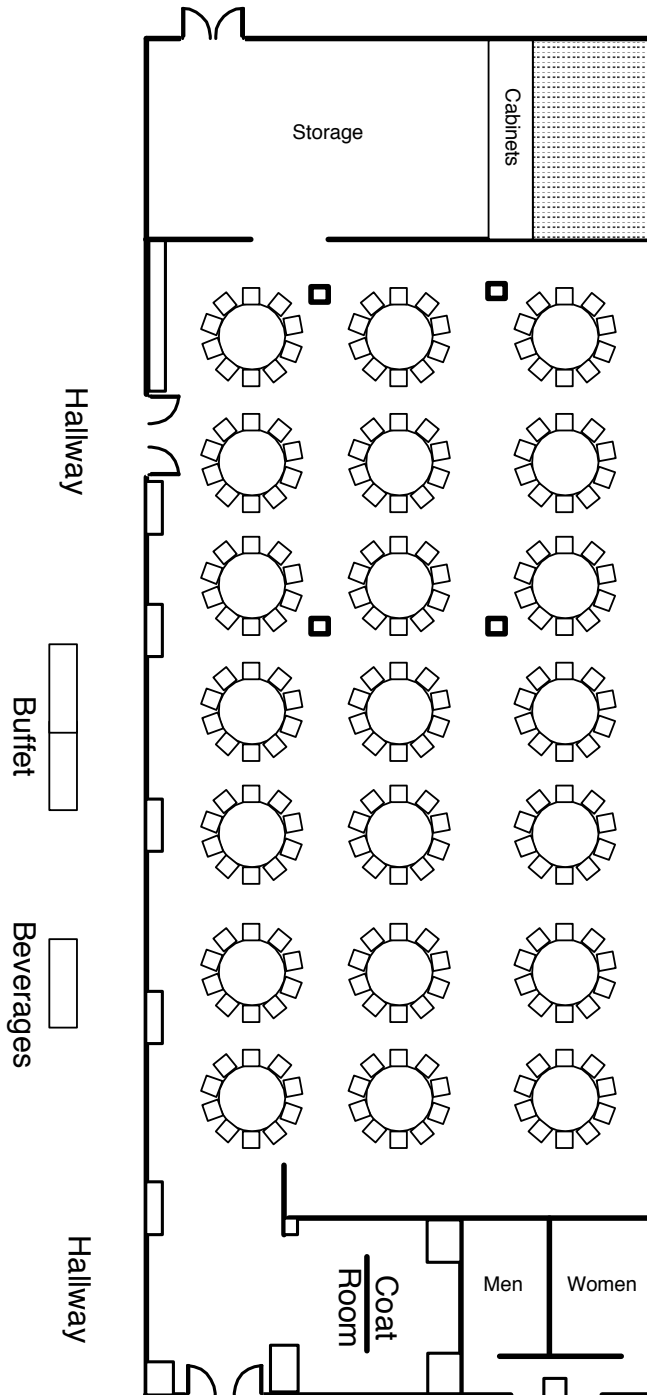



VENUE : INTERNATIONAL MARKET SQUARE

FLOOR PLAN

EVENT : STUDIO 185 COCKTAIL RECEPTION

GUEST CAPACITY: 200

**TABLES:**

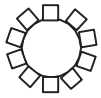

5 ROUNDS OF 10 SEATS



LOW COCKTAIL TABLES



HIGH COCKTAIL TABLES

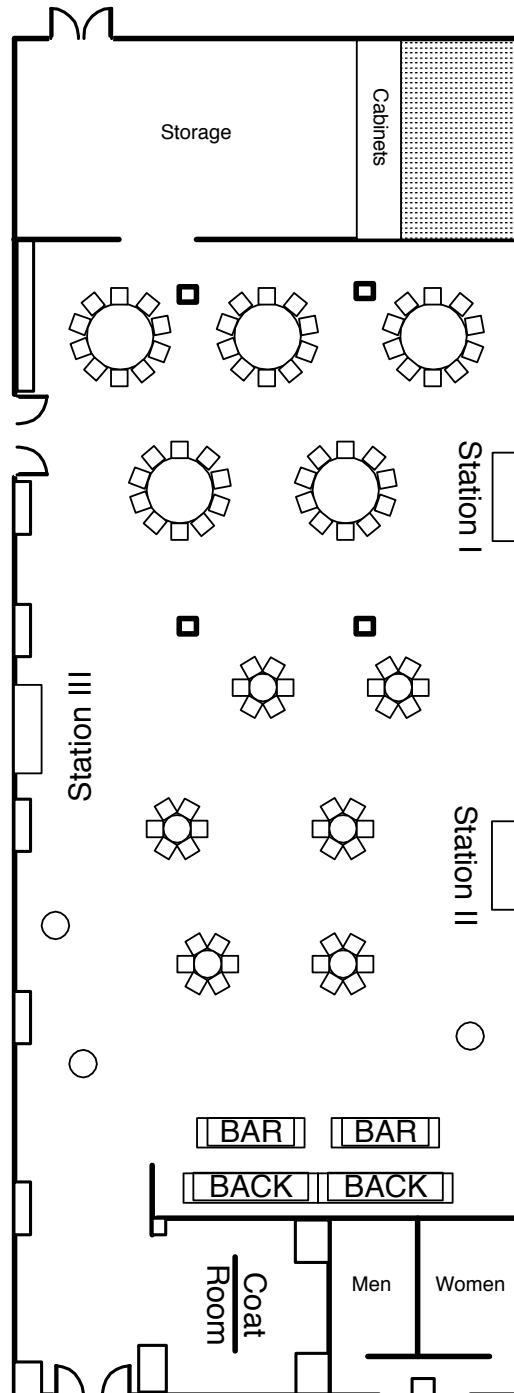

VENUE : INTERNATIONAL MARKET SQUARE

FLOOR PLAN

EVENT : STUDIO 185 MEETING

GUEST CAPACITY: 105

**TABLES:**

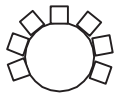

15 ROUNDS OF 7 SEATS

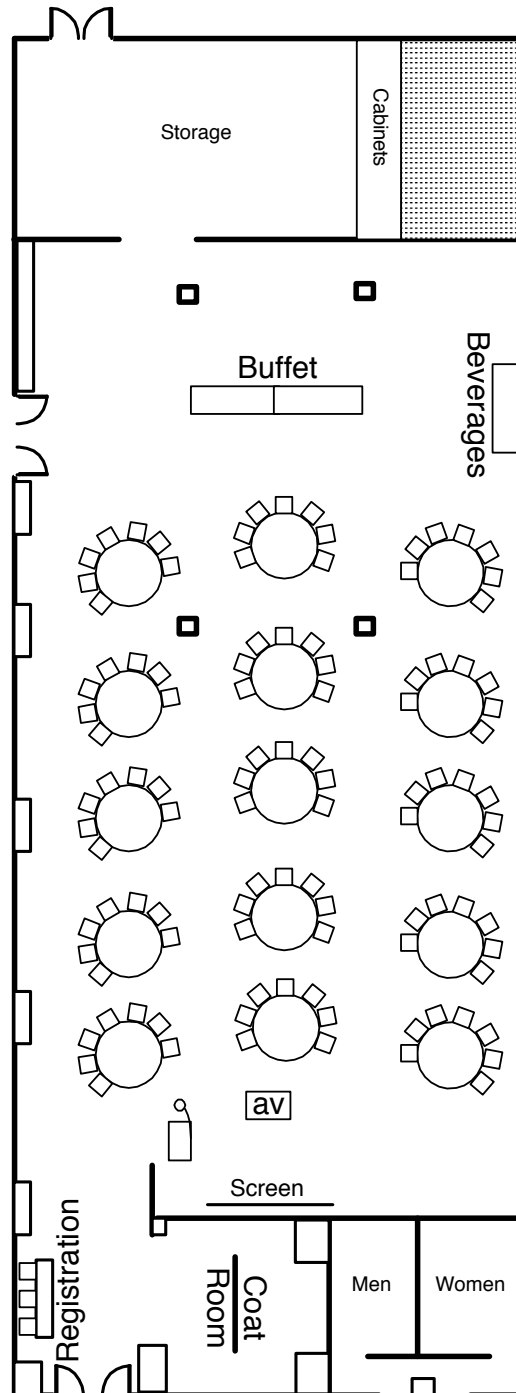

VENUE : INTERNATIONAL MARKET SQUARE

FLOOR PLAN

EVENT : STUDIO 185 MAXIMUM CAPACITY

GUEST CAPACITY: 210

TABLES:

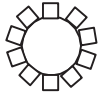

21 ROUNDS OF 10 SEATS

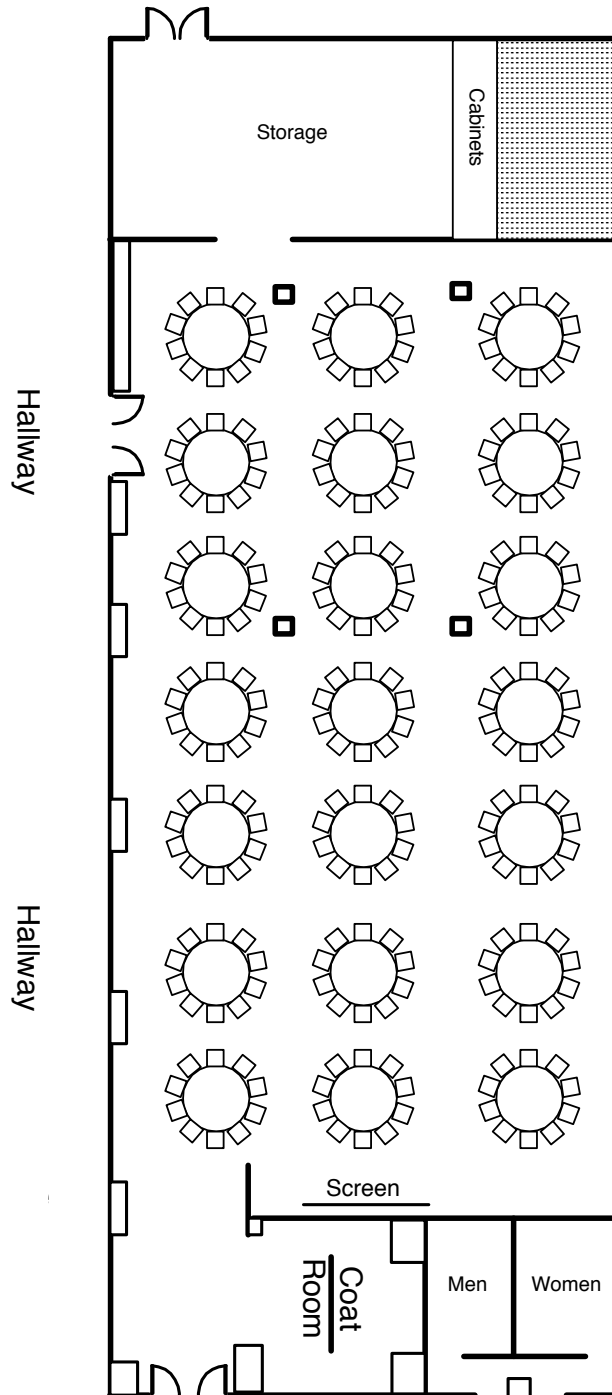

EVENT : STUDIO 185 WEDDING RECEPTION

GUEST CAPACITY: 120

**TABLES:**

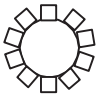

10 ROUNDS OF 10 SEATS

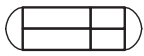

HEAD TABLE OF 20 SEATS



LOW COCKTAIL TABLES



HIGH COCKTAIL TABLES

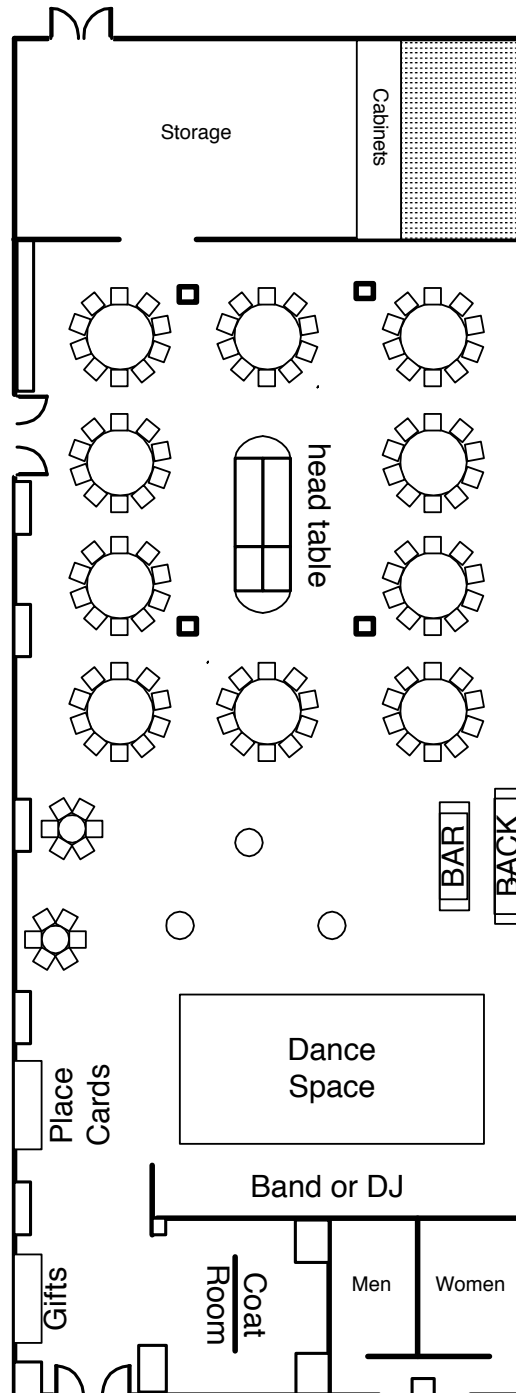

EVENT : STUDIO 185 MEASUREMENTS

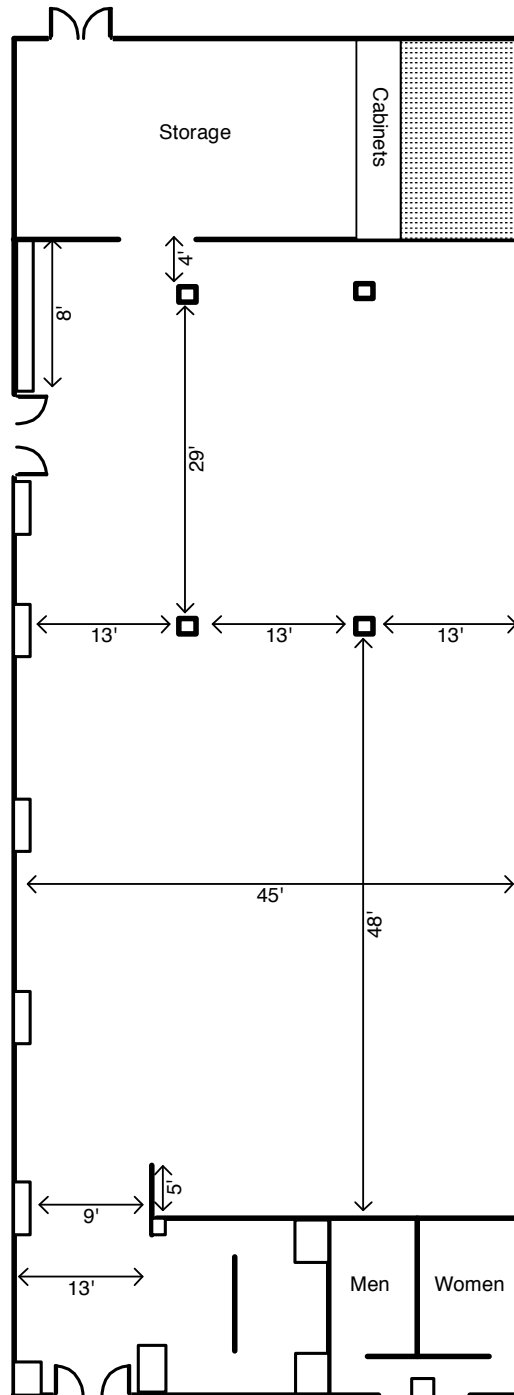

EVENT : STUDIO 185 ELECTRICAL OUTLETS

X = ELECTRICAL OUTLETS

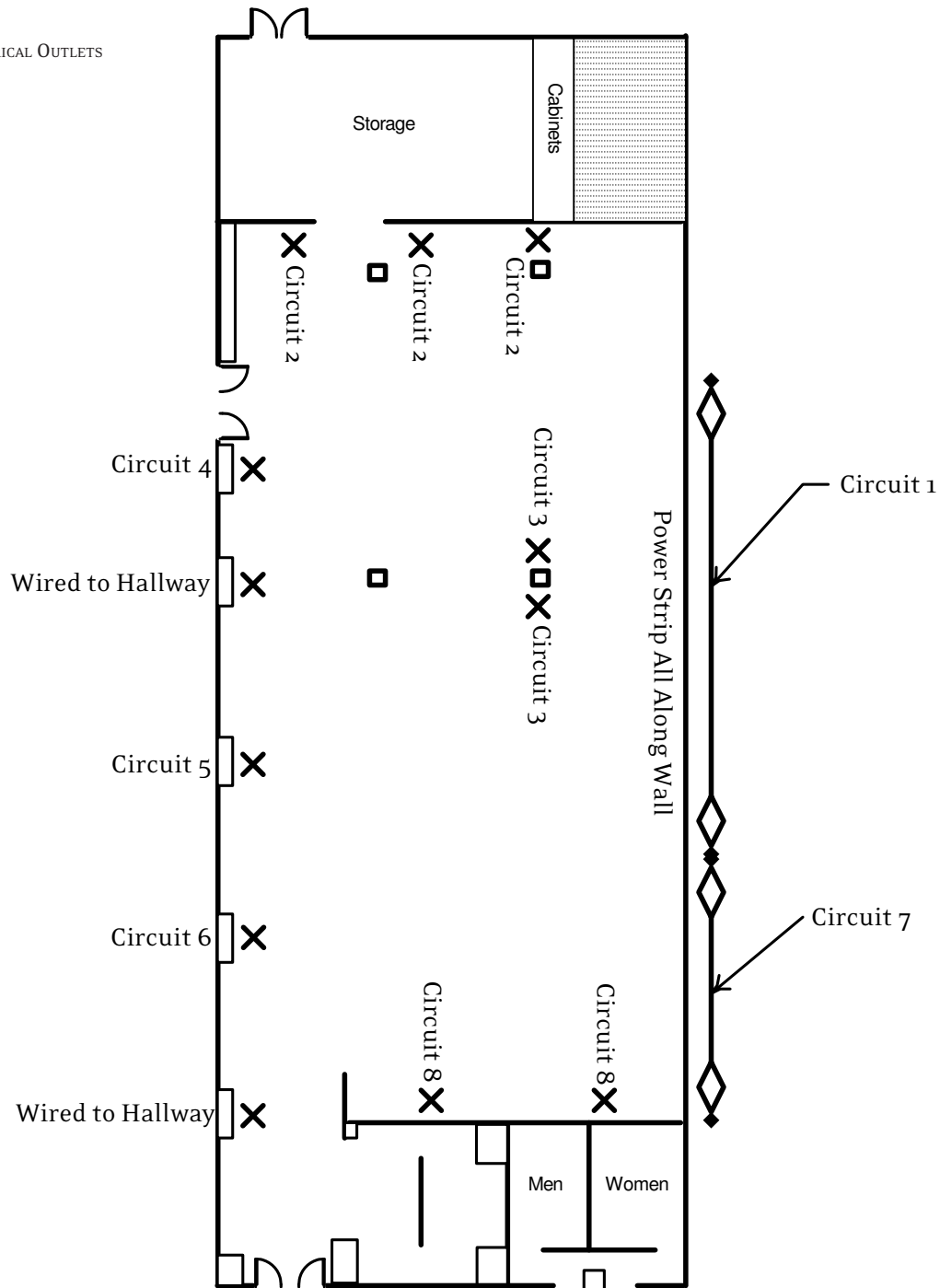

VENUE: **INTERNATIONAL MARKET SQUARE**

CREDIT CARD AUTHORIZATION

OFFICE USE ONLY

EO # \_\_\_\_\_  
VENUE \_\_\_\_\_



**D'AMICO**  
CATERING

**\* CREDIT CARD AUTHORIZATION FORM \***

I GIVE AUTHORIZATION TO D'AMICO CATERING TO CHARGE MY DEBIT or CREDIT CARD TO  
PAY FOR:

Name of Event: \_\_\_\_\_

Date of Event: \_\_\_\_\_

D'Amico Catering Event Planner: \_\_\_\_\_

**DEBIT CARD** (circle one): Visa      Am Ex      Discover      Mastercard

Card Number: \_\_\_\_\_

Expiration Date: \_\_\_\_\_

Daily Limit: \_\_\_\_\_

**CREDIT CARD** (circle one): Visa      Am Ex      Discover      Mastercard

Card Number: \_\_\_\_\_

Expiration Date: \_\_\_\_\_

Name (as it appears on card): \_\_\_\_\_

Statement Billing Address: \_\_\_\_\_

Zip Code: \_\_\_\_\_

**Signature of Card Holder:** \_\_\_\_\_

**Date:** \_\_\_\_\_

**CARD TO BE USED FOR:** Deposit      Pre-Payment & Final Payment  
(circle all that apply)

**Specific Amount:**  
(if known) \_\_\_\_\_

**YOUR SIGNATURE ABOVE CONFIRMS YOUR AGREEMENT TO ALLOW D'AMICO CATERING TO CHARGE THE CREDIT CARD ABOVE FOR YOUR EVENT. IF NO OTHER FORM OF PAYMENT IS PROVIDED PRIOR TO DATE OF EVENT, AND D'AMICO HAS NOT BEEN ADVISED OTHERWISE, ANY OUTSTANDING CHARGES FOR YOUR EVENT WILL BE CHARGED TO THE CARD ABOVE. IF A REFUND IS ISSUED IT WILL BE APPLIED TO THE CARD WITH THE HIGHEST DOLLAR AMOUNT CHARGED UNLESS A SPECIFIED CARD IS CHOSEN.**

**\*\* A FAX COPY OF THIS AUTHORIZATION SHALL BE AS VALID AS THE ORIGINAL \*\***

Please return this form to D'Amico Catering Fax: (612) 238-4040/Tel: (612) 238-4444

VENUE: **INTERNATIONAL MARKET SQUARE**

**DIRECTIONS**

**LOCATION AND CONTACT:**

D'Amico Catering at  
International Market Square  
275 Market Street  
Minneapolis, MN 55405

Phone: 612.238.4444  
Fax: 612.238.4040

International Market Square is located on the corner of Lyndale and Glenwood Avenues. Exit Interstate 94 via Olson Memorial/Highway 55. From I-394, exit Highway 100 north to Glenwood Avenue east.

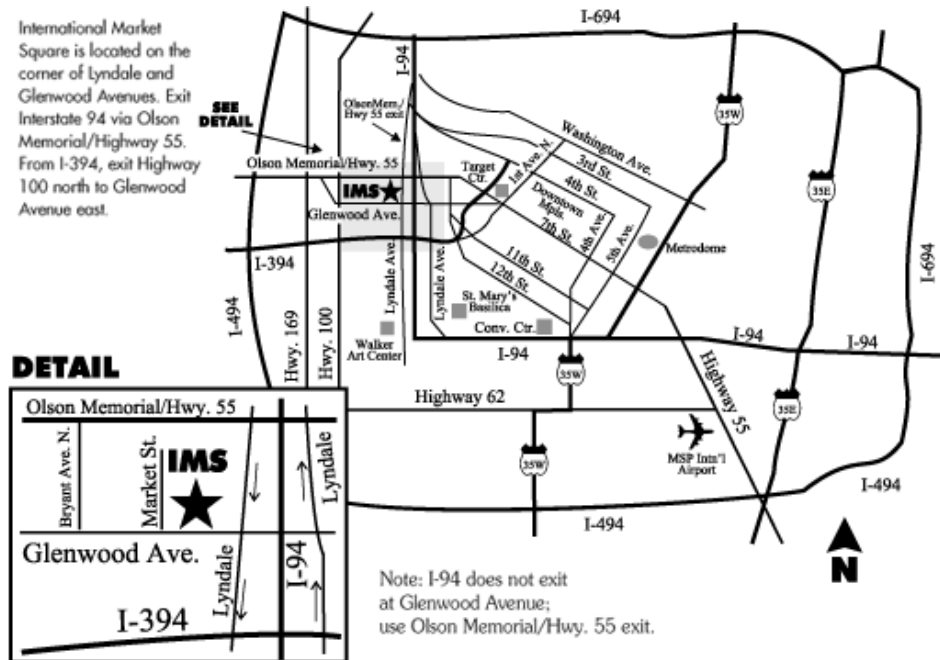

**DIRECTIONS TO INTERNATIONAL MARKET SQUARE**

**FROM THE WEST** Take I-394 East to Penn Avenue North, take a left on Penn. Follow to Cedar Lake Road and take a right. Follow to Glenwood and take a right. Follow ½ mile to IMS and take a left into the entrance.

**FROM THE NORTH** Take I-94 East to exit 230 (4th Street, 7 Street, Hwy 55). Bear right (the sign will say 7th Street and Hwy 55) then continue straight. Road becomes Lyndale Avenue southbound; follow to Glenwood and take a right. Take an immediate right into IMS entrance.

**FROM THE EAST** Take I-94 West, through the tunnel, and take the Highway 55/Olson Memorial Highway exit (exit 230). Stay to the left lane; turn left on Highway 55, and then take an immediate left onto Lyndale Avenue. Go one block to Glenwood, take a right, then take the first right into the IMS entrance.

**FROM THE SOUTH** Follow Lyndale Avenue North to Glenwood; take a right. Travel one block to the IMS entrance and take a right. Or, take I-35W to 94 West to Lyndale Avenue North, follow to Glenwood and take a left, then a right into the IMS entrance.

**FROM THE SOUTHWEST** Take Highway 100 North to Glenwood Avenue. Take a left on Glenwood and head east toward downtown. Just before Lyndale Avenue, take a left into the IMS entrance.

**FROM DOWNTOWN MINNEAPOLIS** Take 7th Street North just past the Target Center and take the first left (just beyond the Target Center parking ramp onto 3rd Avenue, which becomes Glenwood Avenue. Follow to IMS and take a right into the entrance. Or, take 11th Street North, cross 1st Avenue, and the road will become 12th Street. Follow to Glenwood and take a left. Cross under I-94 and take the first right into the IMS entrance.



VENUE : **INTERNATIONAL MARKET SQUARE**

FLOOR PLAN

**EVENT : PARKING DIAGRAM** No overnight parking without landlord approval

