

| Room Name | Size | | | Approximate Room Capacities | | | | | | |
|------------------------------|--------------|-----------------|------------|-----------------------------|------------|---------------|----------------------|---------------|---------------------|----------------------|
| | Square Feet | Approx. Size | Height | Standing Reception | 72" Rounds | Theater Style | Classroom 18" tables | Hollow Square | Trade Show 8' x 10' | Trade Show 10' x 10' |
| Junior Ballroom 1 | 1,664 | 32'x52' | 12' | 210 | 80 | 196 | 108 | 56 | | |
| Junior Ballroom 2 | 2,392 | 46'x52' | 12' | 290 | 140 | 260 | 171 | 72 | | |
| Junior Ballroom 3 | 1,664 | 32'x52' | 12' | 210 | 80 | 196 | 108 | 56 | | |
| Junior Ballroom Total | 5,720 | 110'x52' | 12' | 710 | 300 | 700 | 387 | | 34 | 27 |
| Meeting Room 101 | 1,056 | 32'x33' | 12' | 100 | 50 | 98 | 55 | 32 | | |
| Meeting Room 102 | 1,056 | 32'x33' | 12' | 100 | 50 | 98 | 55 | 32 | | |
| Meeting Room 103 | 1,056 | 32'x33' | 12' | 100 | 50 | 98 | 55 | 32 | | |
| Meeting Room Total | 3,168 | 32'x99' | 12' | 345 | 170 | 345 | 187 | | 18 | 13 |
| Executive Room 100 | 1,890 | 42'x45' | | | | 75 | | | | |
| Lounge | 1,472 | | | 150 | | | | | | |
| North Courtyard | 1,869 | | | 170 | | | | | | |

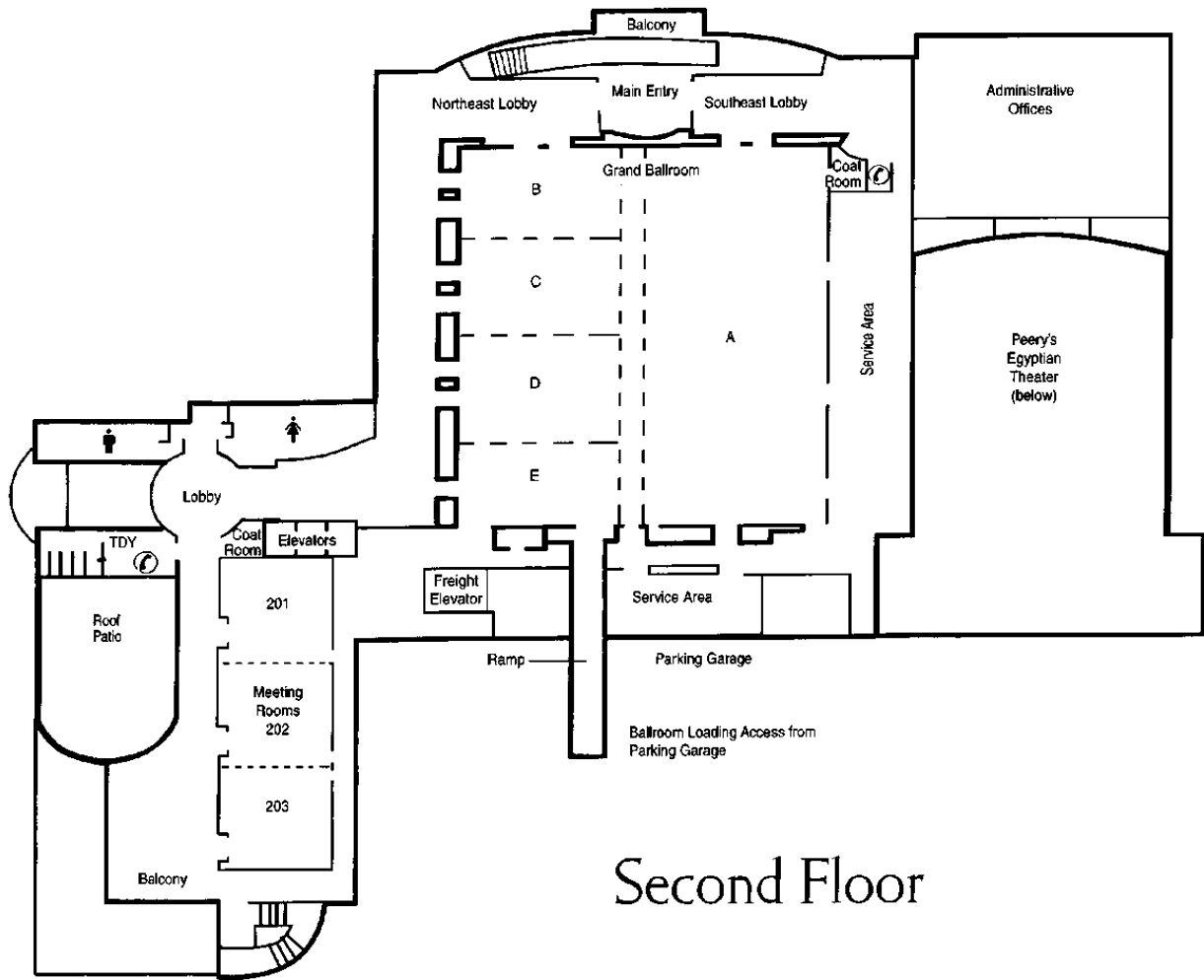

Second Floor

| Room Name | Size | | | Approximate Room Capacities | | | | | | |
|-----------------------------|---------------|------------------|------------|-----------------------------|------------|---------------|----------------------|---------------|---------------------|----------------------|
| | Square Feet | Approx. Size | Height | Standing Reception | 72" Rounds | Theater Style | Classroom 18" tables | Hollow Square | Trade Show 8' x 10' | Trade Show 10' x 10' |
| Grand Ballroom A | 6,888 | 56'x123' | 19' | 900 | 450 | 900 | 550 | | 42 | 42 |
| Grand Ballroom B | 1,488 | 31'x48' | 19' | 185 | 90 | 168 | 96 | 56 | 8 | 7 |
| Grand Ballroom C | 1,488 | 31'x48' | 19' | 185 | 90 | 168 | 96 | 56 | 8 | 7 |
| Grand Ballroom D | 1,488 | 31'x48' | 19' | 185 | 90 | 168 | 96 | 56 | 8 | 7 |
| Grand Ballroom E | 1,488 | 31'x48' | 19' | 185 | 80 | 168 | 96 | 56 | 8 | 7 |
| Grand Ballroom Total | 13,776 | 112'x123' | 19' | 1,640 | 900 | 1,500 | 1,152 | | 77 | 70 |
| Meeting Room 201 | 1,056 | 32'x33' | 12' | 100 | 50 | 100 | 55 | 32 | | |
| Meeting Room 202 | 1,056 | 32'x33' | 12' | 100 | 50 | 100 | 55 | 32 | | |
| Meeting Room 203 | 1,056 | 32'x33' | 12' | 100 | 50 | 100 | 55 | 32 | | |
| Meeting Room Total | 3,168 | 32'x99' | 12' | 345 | 170 | 345 | 187 | | 18 | 13 |